

**DRAWING 7409 100 Rev C3**

NOTE: Refer also to drawing TDS2018-1B

NOTE - Responsibility is not accepted for errors made by others in scaling from this drawing. All construction information should be taken from figured dimensions only

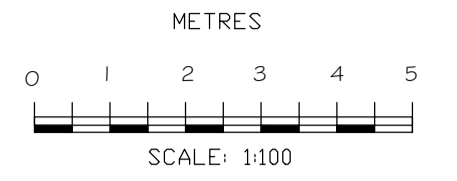

 PROPOSED FOOTWAY WIDENING, FORMATION OF THE SITE ACCESS AND FOOTWAY REINSTATEMENT

 PROPOSED FOOTWAY WIDENING, AREA TO BE DEDICATED AS HIGHWAY

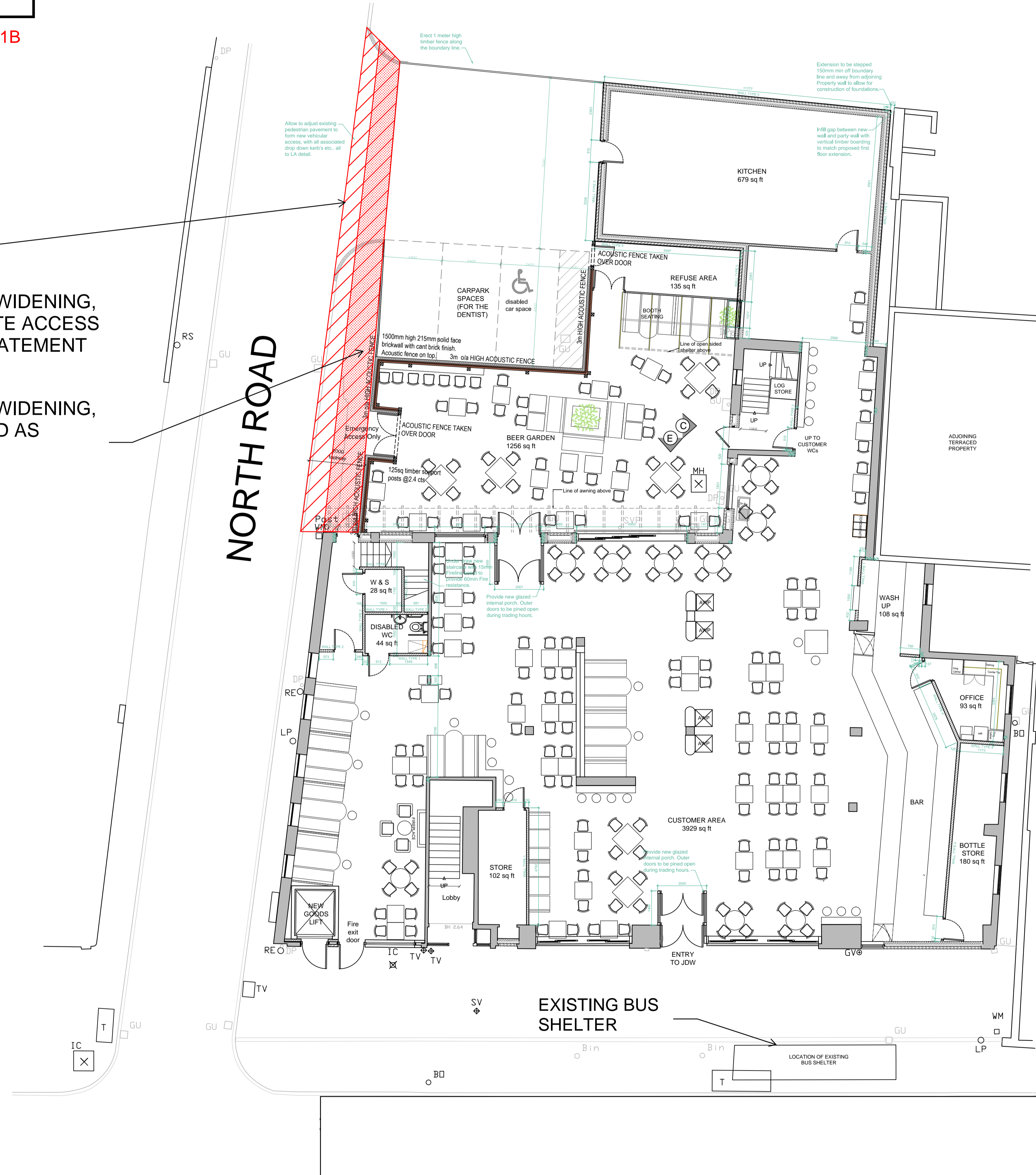

EXISTING BUS STOP CLEARWAY

AUSTHORPE ROAD

REVISIONS

- REV A: CARPARK DRIVE WIDTH INCREASED FROM 6m TO 7m AP/KP 09.06.17
- REV B: BEER GARDEN AREA AMENDED AKS 29.06.17
- REV C: PLANNING REQUIREMENTS: 3METRE HIGH OVERALL ACOUSTIC FENCE, 1500mm lower wall with cant finish and 1500mm Acoustic fence on top. Doors to be Acoustic ACP 19.07.17

**kdp**a kdesign  
 kdproject management  
 kdarchitecture

Adur Business Centre  
 Little High Street  
 Shoreham by Sea  
 West Sussex BN43 5EG

T: 01273 467518  
 E: info@kdpaine.co.uk  
 W: www.kdpaine.co.uk

|            |   |            |          |
|------------|---|------------|----------|
| CLIENT     | JD WETHERSPOON PLC                                      |            |          |
| PROJECT    | PUB NO: 7402<br>CHURCH VIEW SURGERY<br>CROSSGATE, LEEDS |            |          |
| DRAWING    | PROPOSED GROUND FLOOR<br>OPTION 2                       |            |          |
| SCALE      | A/1:100   | DATE       | JUN 2017 |
| PROJECT No | 7409  | DRAWING No | 100      |
| DRAWN      | AKS   | REVISION   | C        |